

# Cranial Fixation Systems



Aesculap Neurosurgery

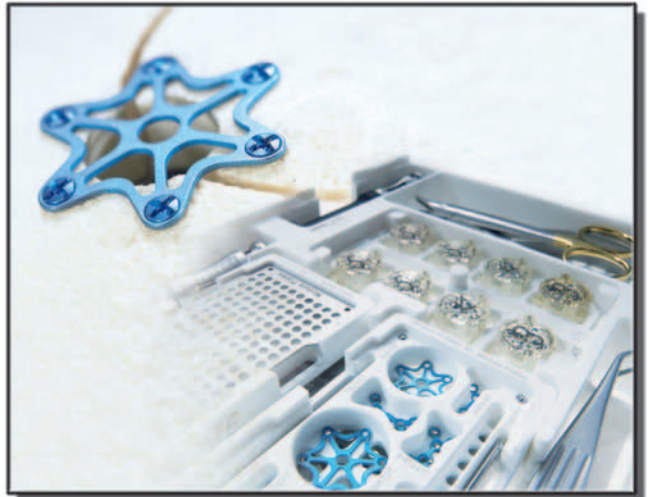
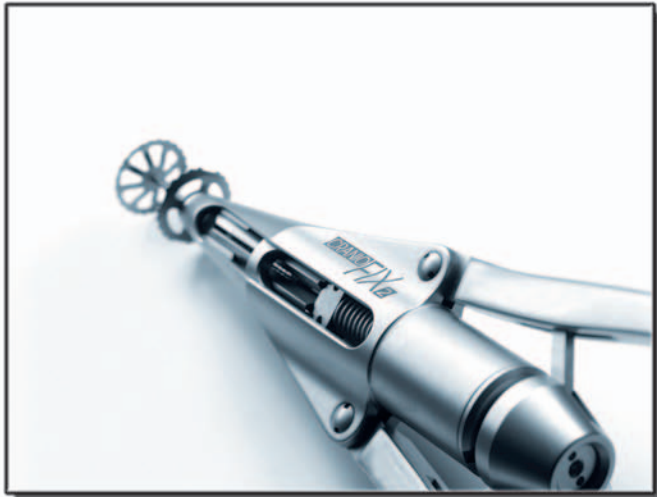
AESCULAP®



# Cranial Fixation Systems

Surgeries of the brain and spine are among the most delicate and demanding procedures in the field of medicine. As a neurosurgeon, you expect excellence from the instruments and devices you use to treat your patients. Aesculap's exacting standards and commitment to quality have made us a trusted choice for neurosurgeons worldwide. From initial incision to complete closure, our treatment solutions will help you to provide outstanding patient care.

Aesculap offers a full range of products for the fixation of cranial bone flaps and fractures. With everything from double-sided fixation, to plates and screws, Aesculap is the solution for all of your cranial fixation needs!



# CranioFix® 2

## Secure, Safe, Fast – Titanium Cranial Fixation System

Since its introduction in 1997, Aesculap's CranioFix titanium clamp system has been an outstanding success. As the first double-sided fixation system on the market, CranioFix revolutionized neurosurgery by giving neurosurgeons a way to achieve maximum flap stability while saving valuable time in the operating room.

Aesculap improved on its history of success with the next generation of cranial fixation, the CranioFix 2. An improved pin-grasping mechanism makes clamp application up to 40% faster than with the first generation CranioFix. Bone flaps are fixed in less than two minutes! Grounded in proven CranioFix technology, this new system raised the bar on speed, efficiency and reliability.

In the past 15 years, 2.5 million clamps have been implanted in over 700,000 patients worldwide! Currently, more than 200 patients are treated with CranioFix each day.

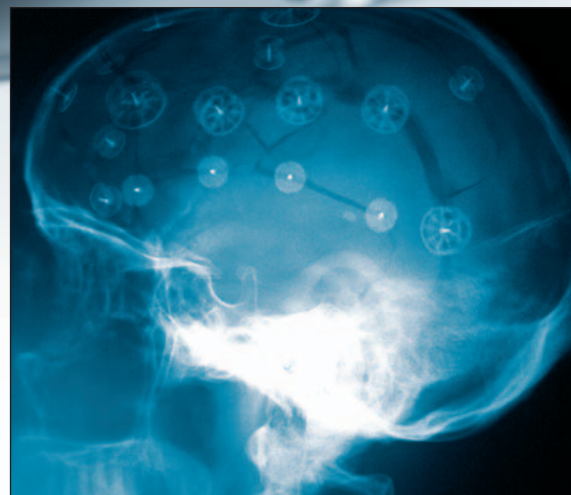
### Features and Benefits

- The screwless design saves you time in the operating room by eliminating your need to pre-drill and manage many small parts.
- Simply position the clamps, replace the bone flap, secure and tighten the clamps and cut the residual pins. Cranial fixation doesn't get much easier!
- Atraumatic design of the titanium clamps helps ensure rapid and safe healing
- Low profile clamps provide excellent cosmetic results
- MR Conditional
- Patented strain-relief mechanism ensures that clamps are applied with the same amount of strength every time
- No manual cleaning and no disassembly/reassembly required – allows for improved and accelerated reprocessing



#### Indications for Use

Aesculap CranioFix 2 System is intended for use in the fixation of cranioplasty plates, covering burr holes, and fixation of cranial fractures. See Instructions for Use for additional information regarding Warnings and Precautions. Rx only



### ■ Optimal Surgical Outcome

The atraumatic design of CranioFix® 2 titanium clamps helps ensure rapid and safe healing while their low profile provides excellent cosmetic results.



# Ordering Information

## Description of Instruments

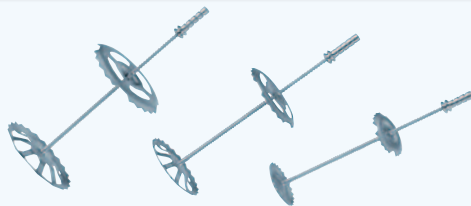
### Patient ID

For easy postoperative radiological identification of the CranioFix® 2 implants, specially developed multilingual patient IDs are available for the patients.



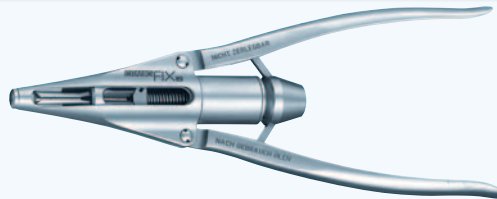
### CranioFix 2 Implants

- FF490T CranioFix 2 clamp, 11 mm (box of 12)
- FF491T CranioFix 2 clamp, 16 mm (box of 6)
- FF492T CranioFix 2 clamp, 20 mm (box of 6)



### CranioFix 2 Instruments

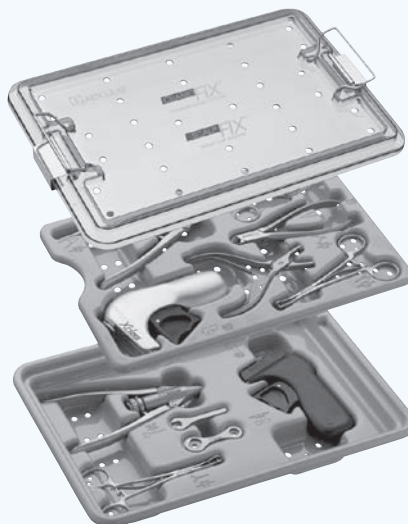
- FF494R CranioFix 2 applier with automatic strain relief
- FF105R CranioFix 2 holding forceps
- FF103R CranioFix 2 pin cutter
- FF104R CranioFix 2 removal forceps



### CranioFix 2 Trays



**MD119**  
CranioFix 2 Tray  
(instruments not included)



**MD371**  
CranioFix®/ScalpFix tray with lid  
(instruments not included)



**JG598**  
Sterilit® instrument  
oil (bottle)



**JG600**  
Sterilit instrument  
oil (aerosol)

# CranioFix<sup>®</sup> Absorbable

## Instrument-Free, Absorbable Cranial Fixation System

CranioFix Absorbable is a double-sided bone flap fixation system that provides secure cranial fixation upon implantation, but absorbs into the body over a period of two to three years. This system supports the complete osseointegration of cranial flaps in both pediatric and adult patients.

CranioFix Absorbable implants retain approximately 90-95% of their initial strength after 8-12 weeks. As the implants begin to break down, they are metabolized by the body.



Developed in cooperation with  
K.-D. Lerch, M.D.,  
Dortmund, Germany

### Features and Benefits

- Metal-free, absorbable implants dissolve within 24-36 months: will not migrate, do not require secondary surgeries for removal
- Low profile implants ensure optimal cosmetic results, especially in the frontal area: cannot be seen or felt beneath the skin
- Quick three-step, instrument-free application minimizes OR time and eliminates drilling
- Integrated automatic strain-relief mechanism delivers reproducible fixation, while suture chain-block mechanism ensures high clamp stability
- Radiolucent polyester implant material is MRI and CT safe
- Implants are supplied sterile and ready to use. No cleaning, reprocessing or sterilization of additional instrumentation required

### Indications for Use

Aesculap's Absorbable CranioFix is intended for fixation of cranial bone flaps.  
See Instructions for Use for additional information regarding Warnings and Precautions. Rx only

# CranioFix<sup>®</sup> Absorbable

## Instrument-Free, Absorbable Cranial Fixation System

### Fast & Easy Cranial Fixation

- 1 Position implants
- 2 Pull handle
- 3 Cut suture



Knot-pusher

Self-closing knot

Chain-block  
fixation  
mechanism

Implant

FF016

CranioFix Absorbable, 11 mm, box of 6 implants



FF017

CranioFix Absorbable, 16 mm, box of 6 implants

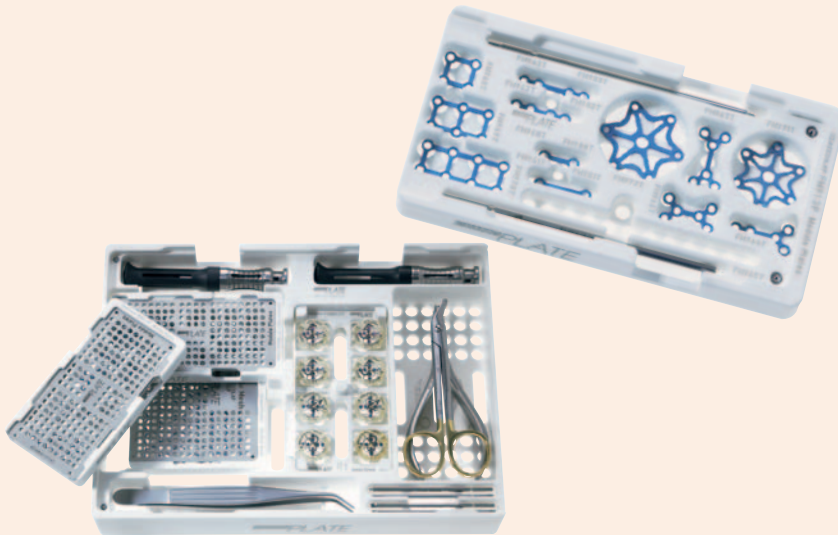




# CranioPlate™

## Modular Plate & Screw Cranial Fixation System

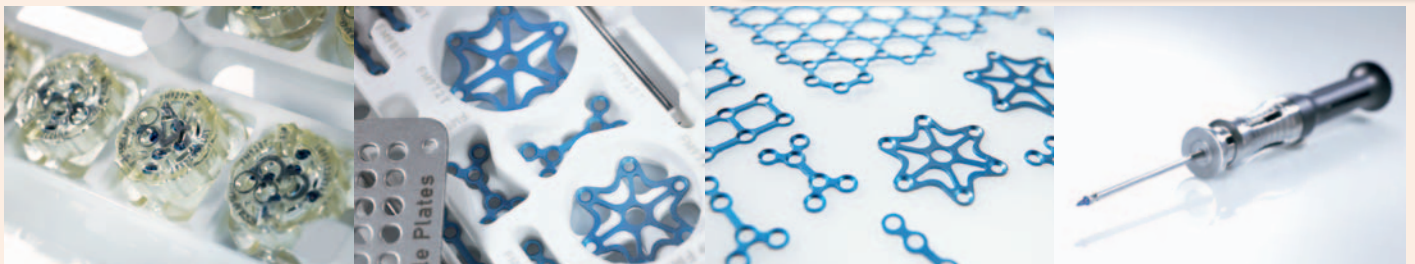
CranioPlate has been specially developed for the fixation of cranial bone flaps and skull fractures. Its special selection of neurosurgery implants covers all indications in cranial fixation. The distinguishing feature of CranioPlate is its modular storage concept. Low profile plate and screw implants are supplied in clear storage modules. This enables you to load your CranioPlate system with components entirely in accordance with your individual requirements. An open storage concept makes mechanical cleaning possible, even with fully loaded storage units (excluding instruments). Residual water and dirt will be a thing of the past!



### Features and Benefits

- CranioPlate's open storage concept makes mechanical cleaning possible even with fully loaded storage units (excluding instruments).
- Storage units can be housed in all standard trays and containers.
- 0.6 mm low profile plates made from pure titanium provide for an excellent cosmetic result
- Self-drilling screws for ease of use
- Unique screw magazine of the CranioPlate system eliminates the tedious sorting of individual screws

### Implants



### Indications for Use

The Aesculap CranioFacial Plate and Screw System is intended for use in selective trauma of the mid-face and craniofacial skeleton; craniofacial surgery, reconstructive procedures, and selective orthognathic surgery of the maxilla and chin.

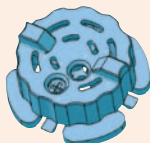
See Instructions for Use for additional information regarding Warnings and Precautions. Rx only

# Ordering Information

## Screw magazine with 8 screws



1.5 mm



Screw magazine with  
8 self-drilling screws,  
cross head

Length 3 mm, **FM920T**  
Length 4 mm, **FM921T**  
Length 5 mm, **FM922T**



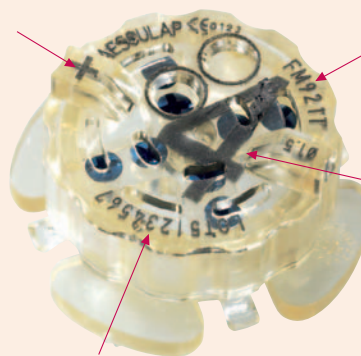
1.8 mm



Screw magazine with  
8 emergency screws,  
self-tapping, cross head

Length 3 mm, **FM926T**  
Length 5 mm, **FM927T**

Screw profile:  
cross head

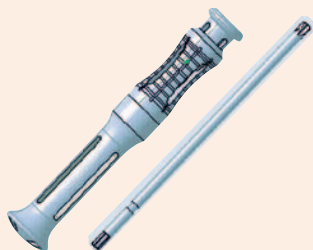


Item number for  
reordering

Screw length:  
3, 4, 5 mm

Lot number for  
patient records

## Instruments



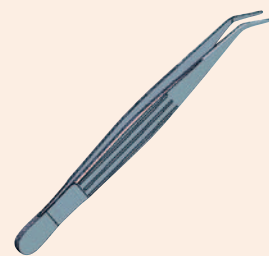
Screwdriver Handle  
1 piece **FM902R**  
Screwdriver blade cross head  
1 piece **FM916R**



Plate cutting forceps  
1 piece **FM903R**

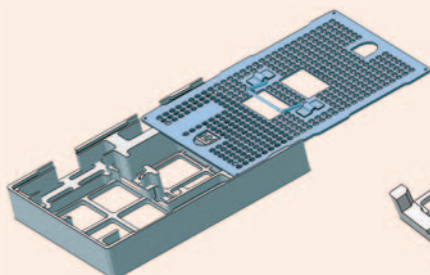


Plate bending forceps  
1 piece **FM904R**

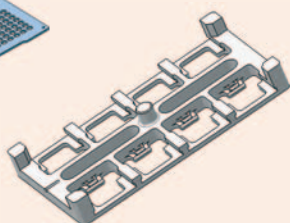


Holding forceps  
1 piece **FM905R**

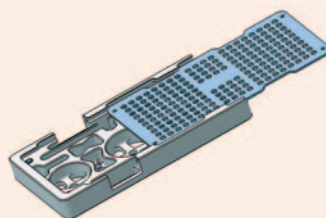
## Storage / modules



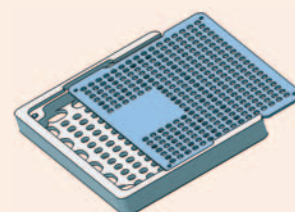
Storage Unit  
1 piece **FM910P**



Screws Module  
1 piece **FM911P**



Plates Module  
1 piece **FM913P**



Mesh Module  
1 piece **FM915P**

## Plates 0.6 mm



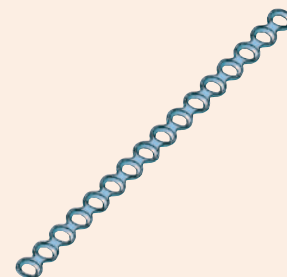
Straight 2 hole, length 11 mm  
1 piece **FM960T**  
5 pieces **FM980T**



Straight 4 hole, length 17 mm  
1 piece **FM962T**  
5 pieces **FM982T**



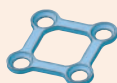
Y plate 5 hole, length 17 mm  
1 piece **FM964T**



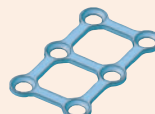
Straight 16 hole, length 63 mm  
1 piece **FM965T**



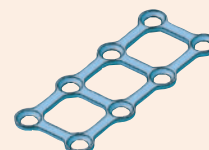
Double Y plate 6 hole,  
length 15 mm  
1 piece **FM966T**  
Double Y plate 6 hole,  
length 17 mm  
1 piece **FM967T**



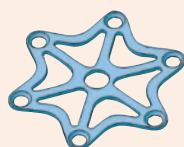
Box car 4 hole, length 10 mm  
1 piece **FM968T**



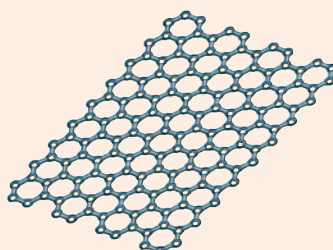
Box car 6 hole, length 17 mm  
1 piece **FM969T**



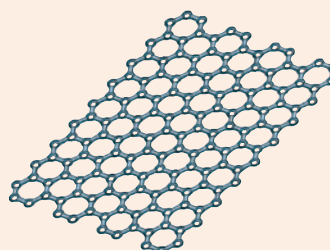
Box car 8 hole, length 24 mm  
1 piece **FM970T**



Burr hole cover 16 mm  
1 piece **FM971T**  
Burr hole cover 20 mm  
1 piece **FM972T**



Mesh 65 x 90 mm, 0.6 mm  
1 piece **FM973T**



Mesh 68 x 91 mm, 0.6 mm  
1 piece **FM974T**



**MD371**  
CranioFix®/ScalpFix tray with lid  
(instruments not included)

All rights reserved. Technical alterations are possible. This leaflet may be used for no other purposes than offering, buying and selling of our products. No part may be copied or reproduced in any form. In the case of misuse we retain the rights to recall our catalogs and price lists and to take legal actions.

©2014 AESCULAP. ALL RIGHTS RESERVED. PRINTED IN THE USA.  
Aesculap is an equal opportunity employer

Aesculap, Inc. | 3773 Corporate Parkway | Center Valley, PA | 18034  
Phone 800-282-9000 | Fax 610-791-6886 | [www.aesculapusa.com](http://www.aesculapusa.com)

Aesculap, Inc. – a B. Braun company

DOC755 Rev B 7/14